

TYP 3F

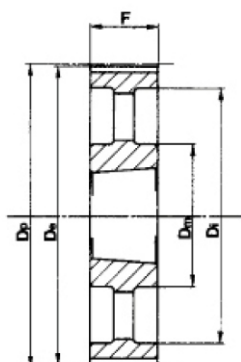

TYP 3A

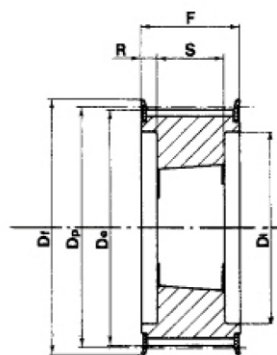

TYP 4F

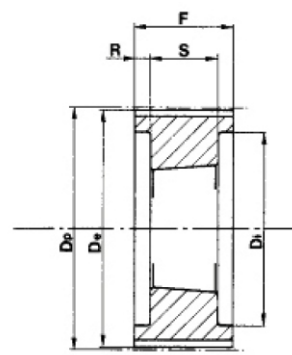

TYP 4

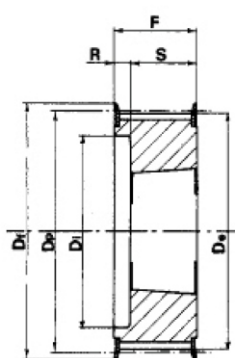

TYP 5F

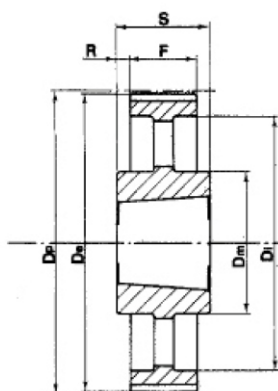

TYP 7A

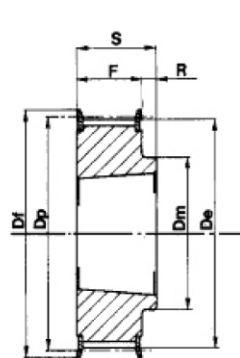

TYP 8F

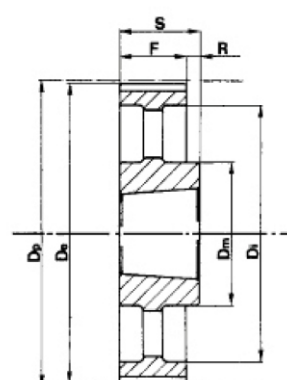

TYP 8A

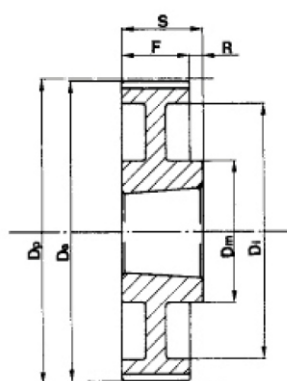

TYP 8W

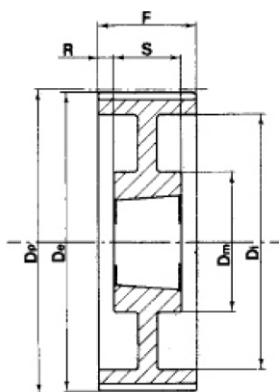

TYP 9W

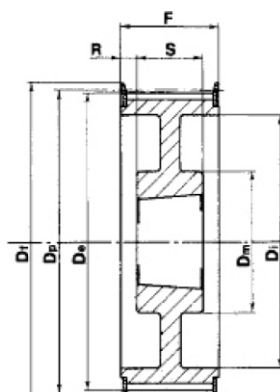

TYP 9WF

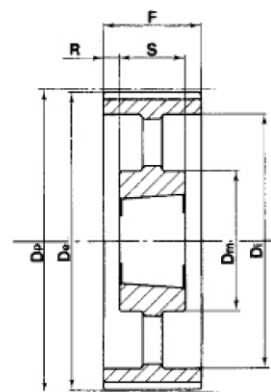

TYP 9A



HTD 5M-15 dla pasa o szerokości 15 mm

| INFORMACJE DODATKOWE | RODZAJ | TYP | TULEJA | OTWÓR MAX | Dp | De | Df | Dm | Di | F | S | R | WAGA KG | |
|----------------------|------------|------------|--------|-----------|----|--------|--------|-----|-----|-----|----|----|---------|---|
| STAL | Z FLANSZĄ | 034-5M-015 | 3F | 1008 | 25 | 54,11 | 52,97 | 57 | - | - | 22 | 22 | - | - |
| | | 036-5M-015 | 3F | 1108 | 25 | 57,30 | 56,15 | 60 | - | - | 22 | 22 | - | - |
| | | 038-5M-015 | 3F | 1108 | 25 | 60,48 | 59,34 | 66 | - | - | 22 | 22 | - | - |
| | | 040-5M-015 | 3F | 1108 | 25 | 63,66 | 62,52 | 70 | - | - | 22 | 22 | - | - |
| | | 044-5M-015 | 3F | 1108 | 25 | 70,03 | 68,89 | 75 | - | - | 22 | 22 | - | - |
| | | 048-5M-015 | 8F | 1210 | 32 | 76,39 | 75,25 | 83 | 59 | - | 22 | 25 | 3 | - |
| | | 056-5M-015 | 8F | 1210 | 32 | 89,43 | 87,98 | 93 | 70 | - | 22 | 25 | 3 | - |
| | | 064-5M-015 | 8F | 1210 | 32 | 101,86 | 100,72 | 106 | 80 | - | 22 | 25 | 3 | - |
| | BEZ TARCZY | 072-5M-015 | 8A | 1610 | 42 | 114,59 | 113,45 | - | 92 | - | 22 | 25 | 3 | - |
| | | 080-5M-015 | 8A | 1610 | 42 | 127,32 | 126,18 | - | 92 | - | 22 | 25 | 3 | - |
| | | 090-5M-015 | 8A | 1610 | 42 | 143,24 | 142,10 | - | 92 | - | 22 | 25 | 3 | - |
| | | 112-5M-015 | 8A | 2012 | 50 | 178,25 | 177,11 | - | 110 | - | 20 | 32 | 12 | - |
| | | 136-5M-015 | 7A | 2012 | 50 | 216,45 | 215,31 | - | 110 | 199 | 20 | 32 | 6 | - |

KOŁA ZĘBATE METRYCZNE POD TULEJĘ TAPER LOCK

HTD 8M-20 dla pasa o szerokości 20 mm

| INFORMACJE DODATKOWE | RODZAJ | TYP | TULEJA | OTWÓR MAX | Dp | De | Df | Dm | Di | F | S | R | WAGA KG | |
|----------------------|-------------|-----------|--------|-----------|----|--------|--------|-----|-----|-----|----|----|---------|------|
| STAL | Z FLANSZĄ | 022-8M-20 | 5F | 1108 | 25 | 56,02 | 54,65 | 60 | - | 37 | 28 | 22 | 6 | 0,25 |
| | | 024-8M-20 | 5F | 1108 | 25 | 61,12 | 59,75 | 66 | - | 44 | 28 | 22 | 6 | 0,30 |
| | | 026-8M-20 | 5F | 1108 | 25 | 66,21 | 64,84 | 70 | - | 45 | 28 | 22 | 6 | 0,36 |
| | | 028-8M-20 | 5F | 1108 | 25 | 71,30 | 70,08 | 75 | - | 50 | 28 | 22 | 6 | 0,44 |
| | | 030-8M-20 | 5F | 1108 | 25 | 76,39 | 75,13 | 83 | - | 58 | 28 | 22 | 6 | 0,53 |
| | | 032-8M-20 | 5F | 1610 | 42 | 94,49 | 80,16 | 87 | - | 63 | 28 | 25 | 3 | 0,42 |
| | | 034-8M-20 | 5F | 1610 | 42 | 86,58 | 85,22 | 91 | - | 64 | 28 | 25 | 3 | 0,55 |
| | | 036-8M-20 | 5F | 1610 | 42 | 91,67 | 90,30 | 97 | - | 68 | 28 | 25 | 3 | 0,68 |
| | | 038-8M-20 | 5F | 1610 | 42 | 96,77 | 95,39 | 102 | - | 72 | 28 | 25 | 3 | 0,80 |
| | | 040-8M-20 | 5F | 1610 | 42 | 101,86 | 100,49 | 106 | - | 76 | 28 | 25 | 3 | 1,00 |
| | | 044-8M-20 | 8F | 2012 | 50 | 112,05 | 110,67 | 120 | 93 | - | 28 | 32 | 4 | 1,20 |
| | | 048-8M-20 | 8F | 2012 | 50 | 122,23 | 120,86 | 128 | 96 | - | 28 | 32 | 4 | 1,60 |
| | | 056-8M-20 | 8F | 2012 | 50 | 142,60 | 141,23 | 150 | 110 | - | 28 | 32 | 4 | 2,40 |
| | | 064-8M-20 | 9WF | 2012 | 50 | 162,97 | 161,60 | 168 | 110 | 137 | 28 | 32 | 4 | 2,70 |
| | | 072-8M-20 | 9WF | 2012 | 50 | 183,35 | 181,97 | 192 | 110 | 158 | 28 | 32 | 4 | 3,30 |
| ŻELIWO | BEZ FLANSZY | 080-8M-20 | 8W | 2012 | 50 | 203,72 | 202,35 | - | 110 | 180 | 28 | 32 | 4 | 3,50 |
| | | 090-8M-20 | 8A | 2012 | 50 | 229,18 | 227,81 | - | 110 | 204 | 28 | 32 | 4 | 3,65 |
| | | 144-8M-20 | 8A | 2517 | 60 | 366,69 | 365,32 | - | 125 | 336 | 28 | 32 | 4 | 4,80 |

HTD 8M-30 dla pasa o szerokości 30 mm

| INFORMACJE DODATKOWE | RODZAJ | TYP | TULEJA | OTWÓR MAX | Dp | De | Df | Dm | Di | F | S | R | WAGA KG | |
|----------------------|-------------|-----------|--------|-----------|----|--------|--------|-----|-----|-----|----|----|---------|------|
| STAL | Z FLANSZĄ | 022-8M-30 | 5F | 1108 | 25 | 56,02 | 54,65 | 60 | - | 37 | 38 | 22 | 16 | 0,31 |
| | | 024-8M-30 | 5F | 1108 | 25 | 61,12 | 59,75 | 66 | - | 44 | 38 | 22 | 16 | 0,38 |
| | | 026-8M-30 | 5F | 1108 | 25 | 66,21 | 64,84 | 70 | - | 44 | 38 | 22 | 16 | 0,45 |
| | | 028-8M-30 | 5F | 1210 | 32 | 71,30 | 70,08 | 75 | - | 50 | 38 | 25 | 13 | 0,50 |
| | | 030-8M-30 | 3F | 1615 | 42 | 76,39 | 75,13 | 83 | - | - | 38 | 38 | - | 0,55 |
| | | 032-8M-30 | 3F | 1615 | 42 | 81,49 | 80,16 | 87 | - | - | 38 | 38 | - | 0,59 |
| | | 034-8M-30 | 3F | 1615 | 42 | 86,58 | 85,22 | 91 | - | - | 38 | 38 | - | 0,77 |
| | | 036-8M-30 | 3F | 1615 | 42 | 91,67 | 90,30 | 97 | - | - | 38 | 38 | - | 0,96 |
| | | 038-8M-30 | 3F | 1615 | 42 | 96,77 | 95,39 | 102 | - | - | 38 | 38 | - | 1,15 |
| | | 040-8M-30 | 3F | 1615 | 42 | 101,86 | 100,49 | 106 | - | - | 38 | 38 | - | 1,34 |
| | | 044-8M-30 | 4F | 2012 | 50 | 112,05 | 110,67 | 120 | - | 86 | 38 | 32 | 3 | 1,33 |
| | | 048-8M-30 | 4F | 2012 | 50 | 122,23 | 120,86 | 128 | - | 90 | 38 | 32 | 3 | 1,78 |
| | | 056-8M-30 | 4F | 2012 | 50 | 142,60 | 141,23 | 050 | - | 110 | 38 | 32 | 3 | 3,76 |
| | | 064-8M-30 | 8F | 2517 | 60 | 162,97 | 161,60 | 168 | 125 | - | 38 | 45 | 7 | 4,20 |
| | | 072-8M-30 | 9WF | 2517 | 60 | 183,35 | 181,97 | - | 125 | 158 | 38 | 45 | 7 | 4,30 |
| ŻELIWO | BEZ FLANSZY | 080-8M-30 | 8W | 2517 | 60 | 203,72 | 202,35 | - | 125 | 180 | 38 | 45 | 7 | 4,60 |
| | | 090-8M-30 | 8A | 2517 | 60 | 229,18 | 227,81 | - | 125 | 204 | 38 | 45 | 7 | 5,00 |
| | | 112-8M-30 | 8A | 2517 | 60 | 285,21 | 283,83 | - | 125 | 254 | 38 | 45 | 7 | 6,20 |
| | | 144-8M-30 | 8A | 2517 | 60 | 366,69 | 365,32 | - | 125 | 336 | 38 | 45 | 7 | 9,00 |

HTD 8M-50 dla pasa o szerokości 50 mm

| INFORMACJE DODATKOWE | RODZAJ | TYP | TULEJA | OTWÓR MAX | Dp | De | Df | Dm | Di | F | S | R | WAGA KG | |
|----------------------|-------------|-----------|--------|-----------|----|--------|--------|-----|-----|-----|----|----|---------|-------|
| STAL | Z FLANSZA | 028-8M-50 | 4F | 1210 | 32 | 71,30 | 70,06 | 75 | - | 50 | 60 | 25 | 17,5 | 0,60 |
| | | 030-8M-50 | 5F | 1615 | 42 | 76,39 | 75,13 | 83 | - | 58 | 60 | 38 | 22 | 0,65 |
| | | 032-8M-50 | 5F | 1615 | 42 | 81,49 | 80,16 | 87 | - | 62 | 60 | 38 | 22 | 0,82 |
| | | 034-8M-50 | 5F | 1615 | 42 | 86,58 | 85,22 | 91 | - | 65 | 60 | 38 | 22 | 1,06 |
| | | 036-8M-50 | 5F | 1615 | 42 | 91,67 | 90,30 | 97 | - | 68 | 60 | 38 | 22 | 1,30 |
| | | 038-8M-50 | 5F | 1615 | 42 | 96,77 | 95,39 | 102 | - | 72 | 60 | 38 | 22 | 1,60 |
| | | 040-8M-50 | 4F | 2012 | 50 | 101,86 | 100,49 | 106 | - | 82 | 60 | 32 | 14 | 1,71 |
| | | 044-8M-50 | 4F | 2012 | 50 | 112,05 | 110,67 | 120 | - | 91 | 60 | 32 | 14 | 1,78 |
| | | 048-8M-50 | 4F | 2012 | 50 | 122,23 | 120,86 | 128 | - | 95 | 60 | 32 | 14 | 2,30 |
| | | 056-8M-50 | 4F | 2012 | 60 | 142,60 | 141,23 | 150 | - | 116 | 60 | 45 | 7,5 | 3,40 |
| | | 064-8M-50 | 4F | 2517 | 60 | 162,97 | 161,60 | 168 | - | 137 | 60 | 45 | 7,5 | 5,00 |
| | | 072-8M-50 | 9WF | 2517 | 60 | 183,35 | 181,97 | 192 | 125 | 158 | 60 | 45 | 7,5 | 6,70 |
| ŻELIWO | BEZ FLANSZY | 080-8M-50 | 4 | 3020 | 75 | 203,72 | 202,35 | - | - | 180 | 60 | 51 | 4,5 | 8,80 |
| | | 090-8M-50 | 9W | 3020 | 75 | 229,18 | 227,81 | - | 170 | 204 | 60 | 51 | 4,5 | 10,00 |
| | | 112-8M-50 | 9W | 3020 | 75 | 285,21 | 283,83 | - | 170 | 260 | 60 | 51 | 4,5 | 12,00 |
| | | 144-8M-50 | 9A | 3020 | 75 | 366,69 | 365,32 | - | 170 | 341 | 60 | 51 | 4,5 | 15,20 |
| | | 168-8M-50 | 7A | 3525 | 90 | 427,81 | 426,44 | - | 198 | 402 | 60 | 65 | 2,5 | 17,50 |
| | | 192-8M-50 | 7A | 3525 | 90 | 488,92 | 487,55 | - | 198 | 460 | 60 | 65 | 2,5 | 24,00 |

HTD 8M-85 dla pasa o szerokości 85 mm

| INFORMACJE DODATKOWE | RODZAJ | TYP | TULEJA | OTWÓR MAX | Dp | De | Df | Dm | Di | F | S | R | WAGA KG | |
|----------------------|-----------|-----------|-------------|-----------|----|--------|--------|--------|--------|-----|----|-----|---------|-------|
| STAL | Z FLANSZA | 034-8M-85 | 4F | 1615 | 42 | 86,58 | 85,22 | 91 | - | 65 | 95 | 38 | 28,5 | 1,43 |
| | | 036-8M-85 | 4F | 1615 | 42 | 91,67 | 90,30 | 97 | - | 68 | 95 | 38 | 28,5 | 1,87 |
| | | 038-8M-85 | 4F | 1615 | 42 | 96,77 | 95,39 | 102 | - | 72 | 95 | 38 | 28,5 | 2,20 |
| | | 040-8M-85 | 4F | 2012 | 50 | 101,86 | 100,49 | 106 | - | 82 | 95 | 32 | 31,5 | 1,80 |
| | | 044-8M-85 | 4F | 2012 | 50 | 112,05 | 110,67 | 120 | - | 91 | 95 | 32 | 31,5 | 2,30 |
| | | 048-8M-85 | 4F | 2517 | 60 | 122,23 | 120,86 | 128 | - | 100 | 95 | 45 | 25 | 2,66 |
| | | 056-8M-85 | 4F | 2517 | 60 | 142,60 | 141,23 | 150 | - | 117 | 95 | 45 | 25 | 4,45 |
| | | 064-8M-85 | 4F | 2517 | 60 | 162,97 | 161,60 | 168 | - | 137 | 95 | 45 | 25 | 6,20 |
| | | 072-8M-85 | 4F | 3020 | 75 | 183,35 | 181,97 | 192 | - | 158 | 95 | 51 | 22 | 8,00 |
| | | ŻELIWO | BEZ FLANSZY | 080-8M-85 | 4 | 3020 | 75 | 203,72 | 202,35 | - | - | 180 | 95 | 51 |
| 080-8M-85 | 9W | | | 3020 | 75 | 229,18 | 227,81 | - | 170 | 204 | 95 | 51 | 22 | 10,80 |
| 112-8M-85 | 9W | | | 3020 | 75 | 285,21 | 283,83 | - | 170 | 260 | 95 | 51 | 22 | 15,00 |
| 144-8M-85 | 9A | | | 3525 | 90 | 366,69 | 365,32 | - | 198 | 336 | 95 | 65 | 15 | 20,00 |
| 168-8M-85 | 9A | | | 3525 | 90 | 427,81 | 426,44 | - | 198 | 395 | 95 | 65 | 15 | 22,00 |
| 192-8M-85 | 9A | | | 3525 | 90 | 488,92 | 487,55 | - | 198 | 455 | 95 | 65 | 15 | 26,00 |

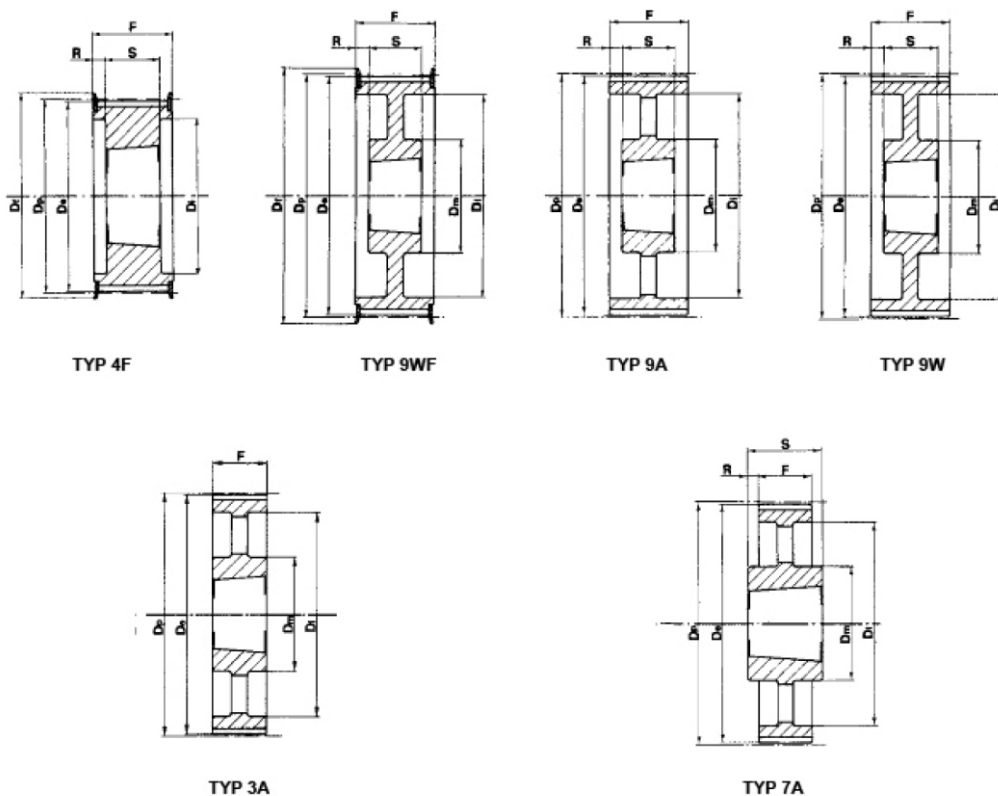

HTD 14M-40 dla pasa o szerokości 40 mm

| INFORMACJE DODATKOWE | RODZAJ | TYP | TULEJA | OTWÓR MAX | Dp | De | Df | Dm | Di | F | S | R | WAGA KG | |
|----------------------|-------------|------------|--------|-----------|----|--------|--------|-----|-----|-----|----|----|---------|-------|
| STAL | Z FLANSZĄ | 028-14M-40 | 4F | 2012 | 50 | 124,78 | 122,12 | 128 | - | 94 | 54 | 32 | 11 | 2,07 |
| | | 029-14M-40 | 4F | 2012 | 50 | 129,23 | 126,57 | 138 | - | 98 | 54 | 32 | 11 | 2,38 |
| | | 030-14M-40 | 4F | 2012 | 50 | 133,69 | 130,99 | 138 | - | 98 | 54 | 32 | 11 | 2,65 |
| | | 032-14M-40 | 4F | 2012 | 50 | 142,60 | 139,88 | 154 | - | 108 | 54 | 32 | 11 | 3,40 |
| | | 034-14M-40 | 4F | 2517 | 60 | 151,52 | 148,79 | 160 | - | 110 | 54 | 45 | 4,5 | 3,87 |
| | | 036-14M-40 | 4F | 2517 | 60 | 160,43 | 157,68 | 168 | - | 120 | 54 | 45 | 4,5 | 4,80 |
| | | 038-14M-40 | 4F | 2517 | 60 | 169,34 | 166,60 | 184 | - | 130 | 54 | 45 | 4,5 | 5,40 |
| | | 040-14M-40 | 4F | 2517 | 60 | 178,25 | 175,49 | 188 | - | 138 | 54 | 45 | 4,5 | 6,00 |
| | | 044-14M-40 | 4F | 3020 | 75 | 196,08 | 193,28 | 212 | - | 155 | 54 | 51 | 1,5 | 7,80 |
| | | 048-14M-40 | 4F | 3020 | 75 | 213,90 | 211,11 | 226 | - | 170 | 54 | 51 | 1,5 | 9,40 |
| ŻELIWO | BEZ FLANSZY | 056-14M-40 | 9WF | 3020 | 75 | 249,55 | 246,76 | 256 | 170 | 208 | 54 | 51 | 1,5 | 10,80 |
| | | 064-14M-40 | 9WF | 3020 | 75 | 285,21 | 282,41 | 296 | 170 | 240 | 54 | 51 | 1,5 | 13,40 |
| | | 072-14M-40 | 9W | 3020 | 75 | 320,86 | 318,06 | - | 170 | 280 | 54 | 51 | 1,5 | 15,20 |
| | | 080-14M-40 | 9A | 3020 | 75 | 356,51 | 353,71 | - | 170 | 315 | 54 | 51 | 1,5 | 16,00 |
| | | 090-14M-40 | 9A | 3020 | 75 | 401,07 | 398,28 | - | 170 | 360 | 54 | 51 | 1,5 | 17,80 |
| | | 112-14M-40 | 9A | 3020 | 75 | 499,11 | 496,32 | - | 170 | 457 | 54 | 51 | 1,5 | 25,60 |
| | | 144-14M-40 | 9A | 3020 | 75 | 641,71 | 638,92 | - | 170 | 600 | 54 | 51 | 1,5 | 32,00 |
| | | 168-14M-40 | 9A | 3020 | 75 | 748,66 | 745,87 | - | 170 | 706 | 54 | 51 | 1,5 | 44,00 |
| | | 192-14M-40 | 9A | 3020 | 75 | 855,62 | 852,82 | - | 170 | 813 | 54 | 51 | 1,5 | 49,00 |
| | | 216-14M-40 | 9A | 3020 | 75 | 962,57 | 959,76 | - | 170 | 920 | 54 | 51 | 1,5 | 55,00 |

HTD 14M-55 dla pasa o szerokości 55 mm

| INFORMACJE DODATKOWE | RODZAJ | TYP | TULEJA | OTWÓR MAX | Dp | De | Df | Dm | Di | F | S | R | WAGA KG | |
|----------------------|-------------|------------|--------|-----------|----|--------|--------|-----|-----|-----|----|----|---------|-------|
| STAL | Z FLANSZA | 028-14M-55 | 4F | 2012 | 50 | 124,78 | 122,12 | 128 | - | 94 | 70 | 32 | 19 | 2,20 |
| | | 029-14M-55 | 4F | 2012 | 50 | 129,23 | 126,57 | 138 | - | 100 | 70 | 32 | 19 | 2,74 |
| | | 030-14M-55 | 4F | 2517 | 60 | 133,69 | 130,99 | 138 | - | 100 | 70 | 45 | 12,5 | 2,70 |
| | | 032-14M-55 | 4F | 2517 | 60 | 142,60 | 139,88 | 154 | - | 108 | 70 | 45 | 12,5 | 3,66 |
| | | 034-14M-55 | 4F | 2517 | 60 | 151,52 | 148,79 | 160 | - | 110 | 70 | 45 | 12,5 | 4,55 |
| | | 036-14M-55 | 4F | 2517 | 60 | 160,43 | 157,68 | 168 | - | 120 | 70 | 45 | 12,5 | 5,20 |
| | | 038-14M-55 | 4F | 2517 | 60 | 169,34 | 166,60 | 184 | - | 130 | 70 | 45 | 12,5 | 6,20 |
| | | 040-14M-55 | 4F | 2517 | 60 | 178,25 | 175,49 | 188 | - | 138 | 70 | 45 | 12,5 | 7,00 |
| | | 044-14M-55 | 4F | 3020 | 75 | 196,08 | 193,28 | 212 | - | 155 | 70 | 51 | 9,5 | 8,60 |
| | | 048-14M-55 | 4F | 3020 | 75 | 213,90 | 211,11 | 226 | - | 170 | 70 | 51 | 9,5 | 10,40 |
| | | 056-14M-55 | 9WF | 3020 | 75 | 249,55 | 246,76 | 256 | 170 | 208 | 70 | 51 | 9,5 | 12,40 |
| | | 064-14M-55 | 9WF | 3020 | 75 | 285,21 | 282,41 | 296 | 170 | 240 | 70 | 51 | 9,5 | 14,50 |
| ŻELIWO | BEZ FLANSZY | 072-14M-55 | 9W | 3020 | 75 | 320,86 | 318,06 | - | 170 | 280 | 70 | 51 | 9,5 | 16,20 |
| | | 080-14M-55 | 9A | 3020 | 75 | 356,51 | 353,71 | - | 170 | 315 | 70 | 51 | 9,5 | 17,50 |
| | | 090-14M-55 | 9A | 3020 | 75 | 401,07 | 398,28 | - | 170 | 360 | 70 | 51 | 9,5 | 20,10 |
| | | 112-14M-55 | 9A | 3020 | 75 | 499,11 | 496,32 | - | 170 | 457 | 70 | 51 | 9,5 | 28,40 |
| | | 144-14M-55 | 9A | 3020 | 75 | 641,71 | 638,92 | - | 170 | 600 | 70 | 51 | 9,5 | 36,20 |
| | | 168-14M-55 | 9A | 3020 | 75 | 748,66 | 745,87 | - | 170 | 706 | 70 | 51 | 9,5 | 49,00 |
| | | 192-14M-55 | 9A | 3020 | 75 | 855,62 | 852,82 | - | 170 | 813 | 70 | 51 | 9,5 | 53,00 |
| | | 216-14M-55 | 9A | 3535 | 90 | 962,57 | 959,76 | - | 190 | 920 | 70 | 89 | 9,5 | 65,80 |

HTD 14M-85 dla pasa o szerokości 85 mm

| INFORMACJE DODATKOWE | RODZAJ | TYP | TULEJA | OTWÓR MAX | Dp | De | Df | Dm | Di | F | S | R | WAGA KG | |
|----------------------|-------------|------------|--------|-----------|-----|--------|--------|-----|-----|-----|-----|-----|---------|-------|
| STAL | Z FLANSZA | 028-14M-85 | 4F | 2517 | 60 | 124,78 | 122,12 | 128 | - | 98 | 102 | 45 | 28,5 | 2,70 |
| | | 029-14M-85 | 4F | 2517 | 60 | 129,23 | 126,57 | 138 | - | 100 | 102 | 45 | 28,5 | 3,40 |
| | | 030-14M-85 | 4F | 2517 | 60 | 133,69 | 130,99 | 138 | - | 100 | 102 | 45 | 28,5 | 3,75 |
| | | 032-14M-85 | 4F | 2517 | 60 | 142,60 | 139,88 | 154 | - | 108 | 102 | 45 | 28,5 | 4,80 |
| | | 034-14M-85 | 4F | 2517 | 60 | 151,52 | 148,79 | 160 | - | 110 | 102 | 45 | 28,5 | 6,00 |
| | | 036-14M-85 | 4F | 3020 | 75 | 160,43 | 157,68 | 168 | - | 120 | 102 | 51 | 25,5 | 5,86 |
| | | 038-14M-85 | 4F | 3020 | 75 | 169,34 | 166,60 | 184 | - | 130 | 102 | 51 | 25,5 | 6,80 |
| | | 040-14M-85 | 4F | 3020 | 75 | 178,25 | 175,49 | 188 | - | 138 | 102 | 51 | 25,5 | 8,00 |
| | | 044-14M-85 | 4F | 3020 | 75 | 196,08 | 193,28 | 212 | - | 153 | 102 | 51 | 25,5 | 11,80 |
| | | 048-14M-85 | 4F | 3020 | 75 | 213,90 | 211,11 | 226 | - | 170 | 102 | 51 | 25,5 | 15,10 |
| | | 056-14M-85 | 4F | 3525 | 90 | 249,55 | 246,76 | 256 | - | 210 | 102 | 65 | 18,5 | 19,00 |
| | | 064-14M-85 | 9WF | 3525 | 90 | 285,21 | 282,41 | 296 | 190 | 240 | 102 | 65 | 18,5 | 23,00 |
| ŻELIWO | BEZ FLANSZY | 072-14M-85 | 9W | 3525 | 90 | 320,86 | 318,06 | - | 190 | 280 | 102 | 65 | 18,5 | 25,00 |
| | | 080-14M-85 | 9A | 3525 | 90 | 356,51 | 353,71 | - | 190 | 315 | 102 | 65 | 18,5 | 26,00 |
| | | 090-14M-85 | 9A | 3525 | 90 | 401,07 | 398,28 | - | 190 | 360 | 102 | 65 | 18,5 | 27,80 |
| | | 112-14M-85 | 9A | 3525 | 90 | 499,11 | 496,32 | - | 190 | 457 | 102 | 65 | 18,5 | 36,50 |
| | | 144-14M-85 | 9A | 3525 | 90 | 641,71 | 638,92 | - | 190 | 600 | 102 | 65 | 18,5 | 48,00 |
| | | 168-14M-85 | 9A | 3525 | 90 | 748,66 | 745,87 | - | 190 | 706 | 102 | 65 | 18,5 | 60,00 |
| | | 192-14M-85 | 3A | 4040 | 100 | 855,62 | 852,82 | - | 190 | 813 | 102 | 102 | - | 86,00 |
| | | 216-14M-85 | 3A | 4040 | 100 | 962,57 | 959,76 | - | 190 | 920 | 102 | 102 | - | 91,50 |

KOŁA ZĘBATE METRYCZNE POD TULEJĘ TAPER LOCK

HTD 14M-115 dla pasa o szerokości 115 mm

| INFORMACJE DODATKOWE | RODZAJ | TYP | TULEJA | OTWÓR MAX | Dp | De | Df | Dm | Di | F | S | R | WAGA KG | |
|----------------------|-------------|-------------|--------|-----------|-----|--------|--------|-----|-----|-----|-----|-----|---------|--------|
| STAL | Z FLANSZA | 028-14M-115 | 4F | 2517 | 60 | 124,78 | 122,12 | 128 | - | 98 | 133 | 45 | 44 | 3,77 |
| | | 029-14M-115 | 4F | 2517 | 60 | 129,23 | 126,57 | 138 | - | 100 | 133 | 45 | 44 | 4,00 |
| | | 030-14M-115 | 4F | 2517 | 60 | 133,69 | 130,99 | 138 | - | 100 | 133 | 45 | 44 | 5,00 |
| | | 032-14M-115 | 4F | 2517 | 60 | 142,60 | 139,88 | 154 | - | 108 | 133 | 45 | 44 | 6,80 |
| | | 034-14M-115 | 4F | 2517 | 60 | 151,52 | 148,79 | 160 | - | 110 | 133 | 45 | 44 | 6,80 |
| | | 036-14M-115 | 4F | 3020 | 75 | 160,43 | 157,68 | 168 | - | 125 | 133 | 51 | 41 | 7,00 |
| | | 038-14M-115 | 4F | 3020 | 75 | 169,34 | 166,60 | 184 | - | 130 | 133 | 51 | 41 | 8,40 |
| | | 040-14M-115 | 4F | 3020 | 75 | 178,25 | 175,49 | 188 | - | 138 | 133 | 51 | 41 | 9,20 |
| | | 044-14M-115 | 4F | 3030 | 75 | 196,08 | 193,28 | 212 | - | 155 | 133 | 76 | 28,5 | 14,00 |
| | | 048-14M-115 | 4F | 3030 | 75 | 213,90 | 211,11 | 226 | - | 170 | 133 | 76 | 28,5 | 17,10 |
| | | 056-14M-115 | 4F | 3535 | 90 | 249,55 | 246,76 | 256 | - | 208 | 133 | 89 | 22 | 24,80 |
| ŻELIWO | BEZ FLANSZY | 064-14M-115 | 9WF | 3535 | 90 | 285,21 | 282,41 | 296 | 190 | 240 | 133 | 89 | 22 | 27,00 |
| | | 072-14M-115 | 9W | 3535 | 90 | 320,86 | 318,06 | - | 190 | 280 | 133 | 89 | 22 | 29,00 |
| | | 080-14M-115 | 9A | 3535 | 90 | 356,51 | 353,71 | - | 190 | 315 | 133 | 89 | 22 | 32,00 |
| | | 090-14M-115 | 9A | 3535 | 90 | 401,07 | 398,28 | - | 190 | 360 | 133 | 89 | 22 | 36,50 |
| | | 112-14M-115 | 9A | 3535 | 90 | 499,11 | 496,32 | - | 190 | 457 | 133 | 89 | 22 | 46,00 |
| | | 144-14M-115 | 9A | 4040 | 100 | 641,71 | 638,92 | - | 230 | 600 | 133 | 102 | 15,5 | 68,00 |
| | | 168-14M-115 | 9A | 4040 | 100 | 748,66 | 745,87 | - | 230 | 706 | 133 | 102 | 15,5 | 82,60 |
| | | 192-14M-115 | 9A | 4040 | 100 | 855,62 | 852,82 | - | 230 | 813 | 133 | 102 | 15,5 | 96,00 |
| | | 216-14M-115 | 9A | 4040 | 100 | 962,57 | 959,76 | - | 230 | 920 | 133 | 102 | 15,5 | 107,00 |

HTD 14M-170 dla pasa o szerokości 170 mm

| INFORMACJE DODATKOWE | RODZAJ | TYP | TULEJA | OTWÓR MAX | Dp | De | Df | Dm | Di | F | S | R | WAGA KG | |
|----------------------|-------------|-------------|--------|-----------|-----|--------|--------|-----|-----|-----|-----|-----|---------|--------|
| STAL | Z FLANSZA | 038-14M-170 | 4F | 3030 | 75 | 169,34 | 166,60 | 184 | - | 130 | 187 | 76 | 55,5 | 11,70 |
| | | 040-14M-170 | 4F | 3030 | 75 | 178,25 | 175,49 | 188 | - | 138 | 187 | 76 | 55,5 | 13,00 |
| | | 044-14M-170 | 4F | 3535 | 90 | 196,08 | 193,28 | 212 | - | 153 | 187 | 89 | 49 | 15,00 |
| | | 048-14M-170 | 4F | 3535 | 90 | 213,90 | 211,11 | 226 | - | 170 | 187 | 89 | 49 | 19,00 |
| | | 056-14M-170 | 4F | 3535 | 90 | 249,55 | 246,76 | 256 | - | 208 | 187 | 89 | 49 | 28,50 |
| | | 064-14M-170 | 4F | 4040 | 100 | 285,21 | 282,41 | 296 | - | 240 | 187 | 102 | 42,5 | 41,00 |
| ŻELIWO | BEZ FLANSZY | 072-14M-170 | 9F | 4040 | 100 | 320,86 | 318,06 | - | 230 | 280 | 187 | 102 | 42,5 | 46,90 |
| | | 080-14M-170 | 9F | 4040 | 100 | 356,51 | 353,71 | - | 230 | 315 | 187 | 102 | 42,5 | 48,00 |
| | | 090-14M-170 | 9A | 4040 | 100 | 401,07 | 398,28 | - | 230 | 360 | 187 | 102 | 42,5 | 52,50 |
| | | 112-14M-170 | 9A | 5050 | 125 | 499,11 | 496,32 | - | 265 | 457 | 187 | 127 | 30 | 74,50 |
| | | 144-14M-170 | 9A | 5050 | 125 | 641,71 | 638,92 | - | 265 | 600 | 187 | 127 | 30 | 91,00 |
| | | 168-14M-170 | 9A | 5050 | 125 | 748,66 | 745,87 | - | 265 | 706 | 187 | 127 | 30 | 116,00 |
| | | 192-14M-170 | 9A | 5050 | 125 | 855,62 | 852,82 | - | 265 | 813 | 187 | 127 | 30 | 134,00 |
| | | 216-14M-170 | 9A | 5050 | 125 | 962,57 | 959,76 | - | 265 | 920 | 187 | 127 | 30 | 146,50 |